

Item Number

To determine your item number enter the **RED** option code for each section as in the example below.

A	B	C	D	E	F
PL	I	50	G1	BC	A

A Lock Style

PL Plunger Lock

B Core Type*

I I.C. Core

C Housing Style

50 Round

D Material Installation Kit**USED WITH 50A7 ALPHA CORE**

G1 Glass

M1 Metal

W1 Wood

USED WITH 50B7 ALPHA CORE

G2 Glass

M2 Metal

W2 Wood

STANDARD CORE

G3 Glass

M3 Metal

W3 Wood

E Plating Finish

Extended lead-time and plating lot charges may apply to Special and Custom finishes.

Special Finish	BC	Brushed Chrome
	PC	Polished Chrome
	PB	Polished Brass
	SB	Satin Brass
	BL	Matte Black
	CF	Custom Finish

F Material Thickness

	MINIMUM	MAXIMUM
A	1/4"	3/8"
B	3/8"	1/2"
C	3/4"	7/8"
CL	Custom	

*Cores are not included with this lock.
See page I14 to order or view cores.



Patented

KENSTAN ALPHA CORE HOUSING SHOWN

BACK PLATE

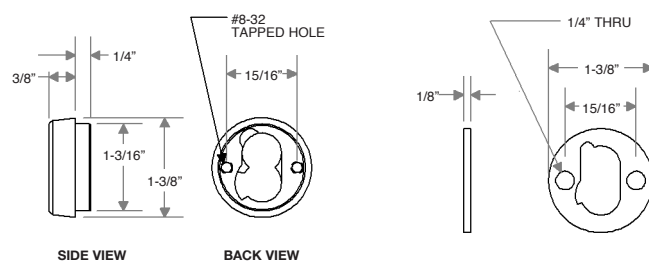
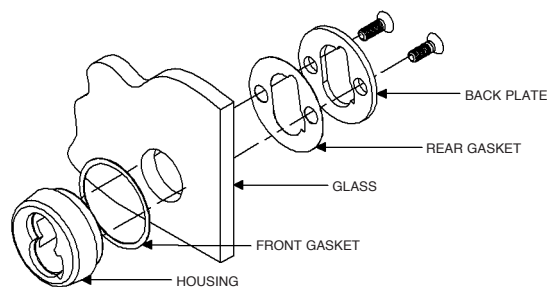
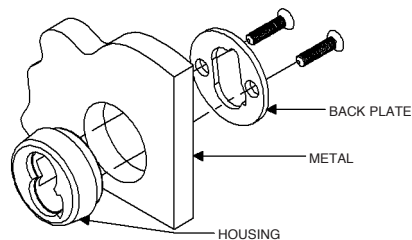
**GLASS INSTALLATION****METAL INSTALLATION****WOOD INSTALLATION**