

Item Number

To determine your item number enter the **RED** option code for each section as in the example below.

A	B	C	D	E	F	G	H	I
PL	S	50	S3	PC	Y	Y	Y	N

A Lock Style

PL Plunger Lock

B Core Type

S ASSA® Desmo
1-1/4" Housing Length

J Removable Core
1-3/4" Housing Length

C Housing Style

50 Round Flange

D Plunger Type/Length**S SERIES**

S1 3/8"

S2 7/16"

S3 5/8"

E Plating Finish

Extended lead-time and plating lot charges
may apply to Special and Custom finishes.

PC Polished Chrome

SC Satin Chrome

PB Polished Brass

BL Black

CF Custom Finish

F Key Retaining

N No

Y Yes

G Keyed Different

N No

Y Yes

H Stamp Lock

N No

Y Yes

I Master Keyed

N No

Y* Yes

*For Master Keyed Core Type **S** locks, the Head Thickness is 5/8".



Pat. Pending

All dimensions shown are in the locked position.
NOTE: A 1.19" hole is required to mount this glass lock.

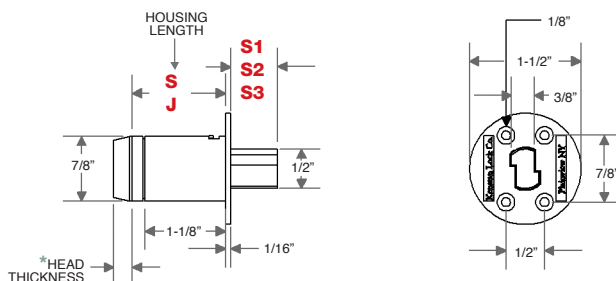
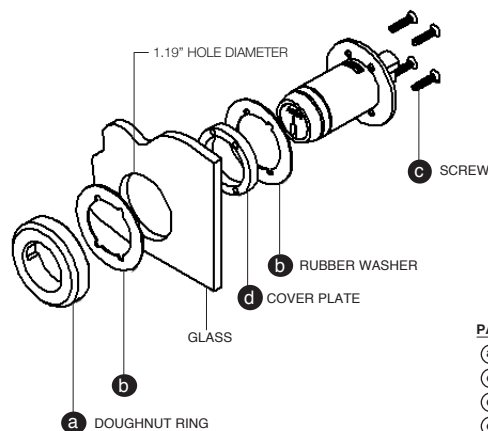
D S SERIES**PLS50 GLASS INSTALLATION**

PARTS INCLUDED	QTY.
a DOUGHNUT	1
c PLASTIC WASHER	2
d PLASTIC SPACER	1
e SCREW	4