

**Item Number**

To determine your item number enter the **RED** option code for each section as in the example below.

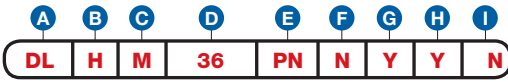

**A Lock Style**

**DL** Drawer/Door Lock

**B Core Type**

**M** Medeco® Biaxial  
**H** Medeco® Biaxial m<sup>3</sup>  
**R** Medeco® Biaxial Removable Core  
**G** Medeco® Biaxial m<sup>3</sup> Removable Core

**C Housing Length**

**M\*** 1-1/16"  
**L** 1-3/16"

**D Bolt Type**

**SNAP BOLT**  
**36** 3/4"

**E Plating Finish**

**PN** Polished Nickel w/Satin Chrome Core  
**PB** Polished Brass  
**SB** Satin Brass  
**BL** Matte Black  
**ST** Statuary Bronze  
**CF** Custom Finish

**F Key Retaining**

**N** No

**G Keyed Different**

**N** No  
**Y** Yes

**H Stamp Lock**

**N** No  
**Y** Yes

**I Master Keyed**

**N** No  
**Y** Yes  
**G** Grand Master

\*Not available in Removable Core.

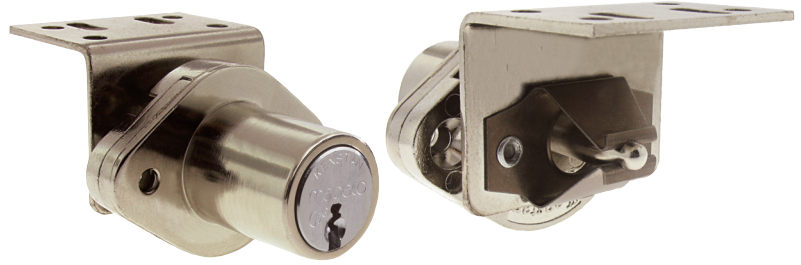

All dimensions shown are in the locked position.

**D SNAP BOLT**

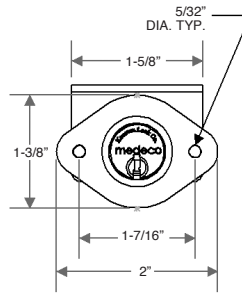

**STRIKE FRONT VIEW**

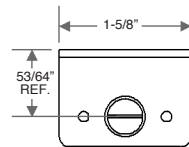

**STRIKE TOP VIEW**

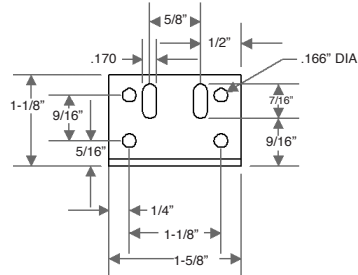

**C HOUSING LENGTH**

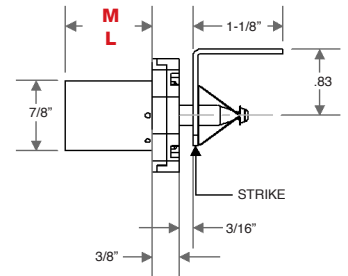

**STRIKE SIDE VIEW**

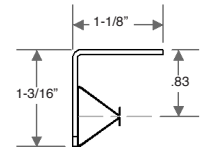

**ISOMETRIC VIEW**

